

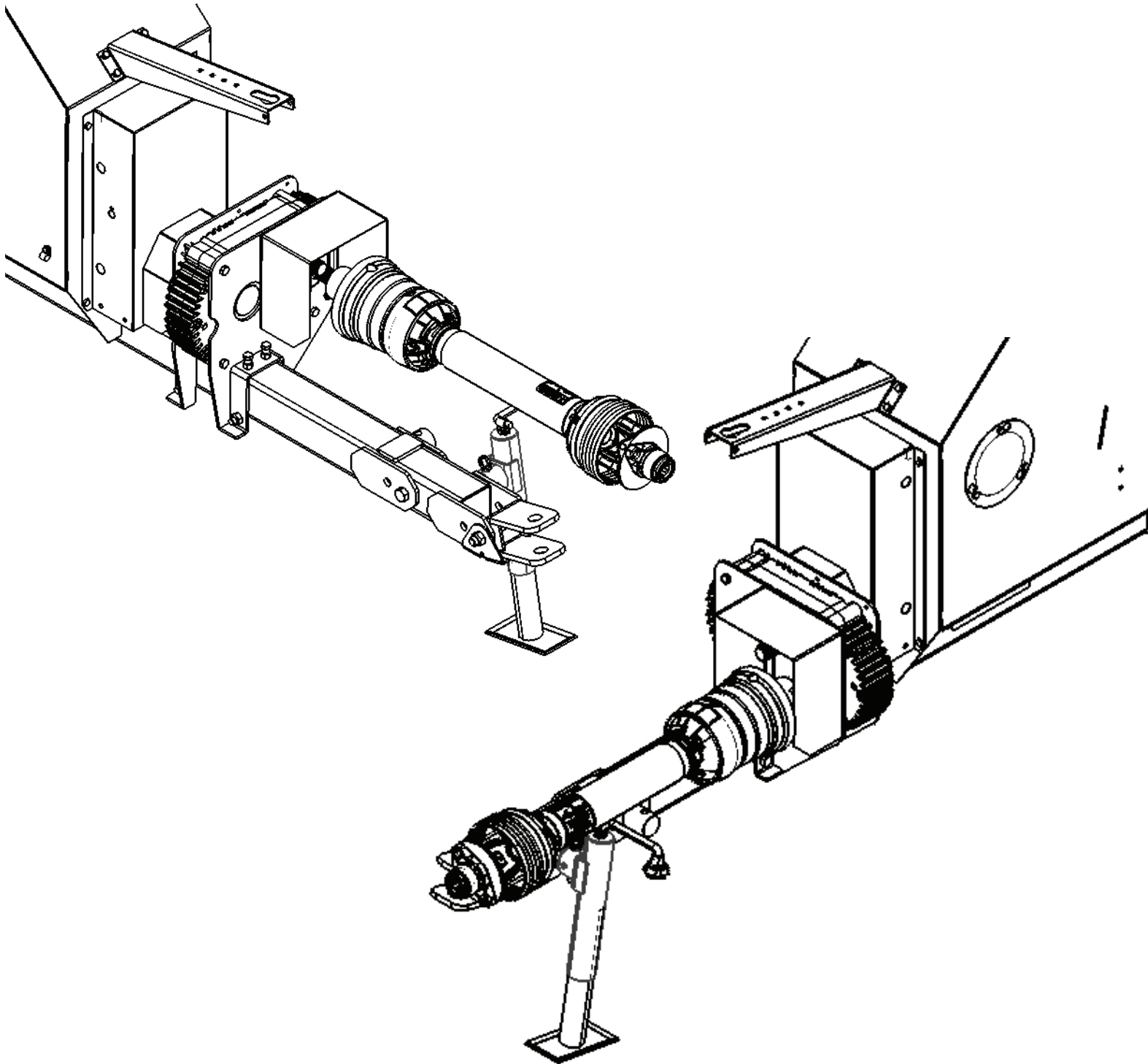

1000-540RPM REDUCER/REVERSER ASSEMBLY & OWNERS MANUAL

Read & understand all instructions pertaining to this option prior to operation!



Safety Alert

Watch for this **ALERT** Symbol. It identifies potential hazards to Personal **SAFETY** and your **HEALTH**. It points out Safety precautions.

This **SAFETY** symbol means:

ATTENTION:

BE ALERT

Why is **SAFETY** important to you?

THREE BIG REASONS:

***ACCIDENTS DISABLE AND KILL**

***ACCIDENTS COST**

***ACCIDENTS CAN BE AVOIDED**

Failure to read this Auger manual before operation of the Auger is a misuse of the equipment and a needless risk to your **HEALTH** and **SAFETY**. Your life and limbs are worth keeping. Use this equipment with care.

Symbol

Signal Words:

DANGER, WARNING, CAUTION

The appropriate signal word for each message has been selected using the following guidelines below the Alert Symbol.



BE ALERT!

DANGER - Indicates an imminently hazardous situation that, if not avoided, will result in death or serious injury. This signal word is to be limited to the most extreme situations, typically for machine components that, for functional purposes, cannot be guarded.

WARNING - Indicates a potentially hazardous situation that, if not avoided, could result in death or serious injury, and includes hazards that are exposed when guards are removed. It may also be used to alert against unsafe practices.

CAUTION - Indicates a potentially hazardous situation that, if not avoided, may result in minor or moderate injury. It may also be used to alert against unsafe practices.

1000-540 Reverser/Reducer Operations Manual

Read and understand this page prior to operation!

Do not operate with guards missing!

Shut tractor off prior to attaching or working with PTO shafts!

Always make sure there is oil in gearbox before running!

After the auger has been positioned, block the tires, front & rear so the auger cannot roll.

Make sure to keep all body parts away from hitch and pto area during operations.

Attach the auger pto shaft to the tractor pto shaft by sliding the knurled collar latch sleeve toward the center of the knuckle cross, then push the auger pto shaft onto the tractor pto shaft until the knurled latch sleeve locks the pto shaft into the groove on the tractor pto shaft.

After making sure the area around the auger pto shaft and swing hopper is clear of people and any loose articles, slowly engage the tractor pto shaft.

With the auger running slow, gradually increase the pto rpm until it reaches operating speed and begin the augering process.

Once the load is empty, let the auger run long enough to empty the auger and then shut off the tractor pto shaft.

After the first load has been unloaded and the pto shaft shut off, check the following:

- 1) Check all fasteners. Make sure they are tight and in the proper position.
- 2) Check position of sprockets. All sprockets should run inline with each other.
- 3) Check chain tension. Make sure idler sprocket hasn't moved & chain has the proper tension.
- 4) Check all set screws. Set screws should be tightened to hold sprockets, couplers, & keys in place.

Lubrication Intervals:

PTO Shaft – grease every 50 hours of operation, both ends of pto shaft with high quality multi-lith grease

Bearings – grease every 50 hours of operation with high quality grease

Drive Chain – lube daily or more with high quality chain lube

Tools Needed To Assemble

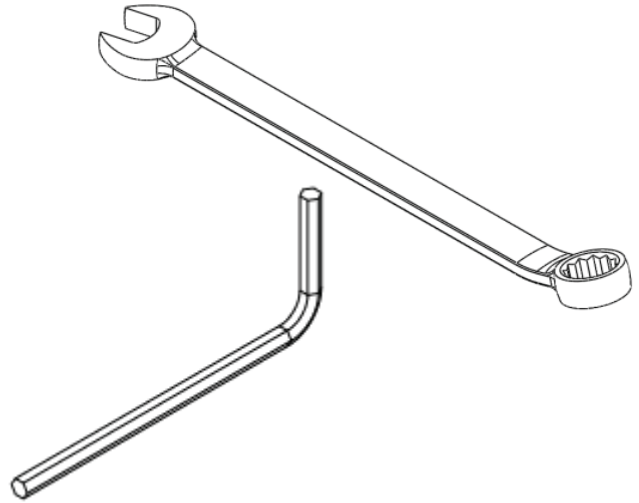
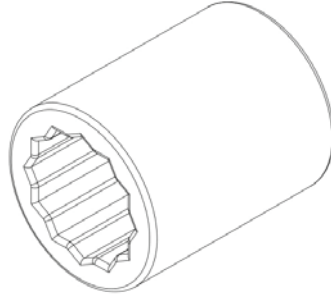
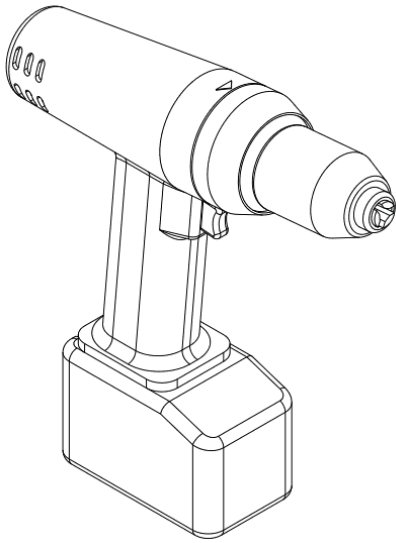

(1) Electric Impact Driver

(1) 1-1/8" Socket

(1) 15/16" Socket

(1) 3/4" Socket

(1) 9/16" Socket

(1) 1-1/8" Wrench

(1) 15/16" Wrench

(1) 3/4" Wrench

(1) 9/16" Wrench

(1) 3/16" Allen Wrench

Step 1

Remove the PTO shaft, PTO support bracket, PTO support chain, & drive chain shield using a 9/16" wrench & socket. Keep the (4) 3/8" bolts & nuts from both the PTO support bracket & the drive chain shield. These will be used in a later step.

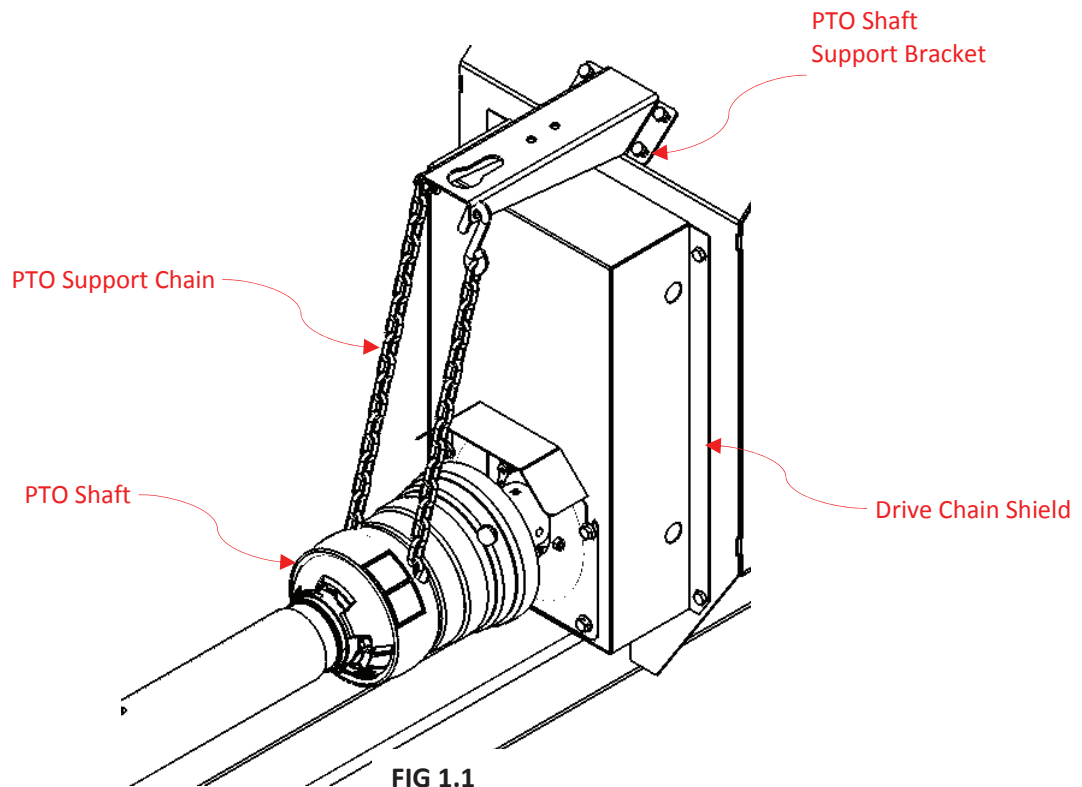

Step 2

Place #60, 20 tooth sprocket (10555) on lower 1-3/4" drive shaft. Make sprocket face flush with end of drive shaft as shown in fig. 2.1. Tighten the (2) 5/16" set screws with a 3/16" allen wrench in the sprocket to 180-190 inch pounds.

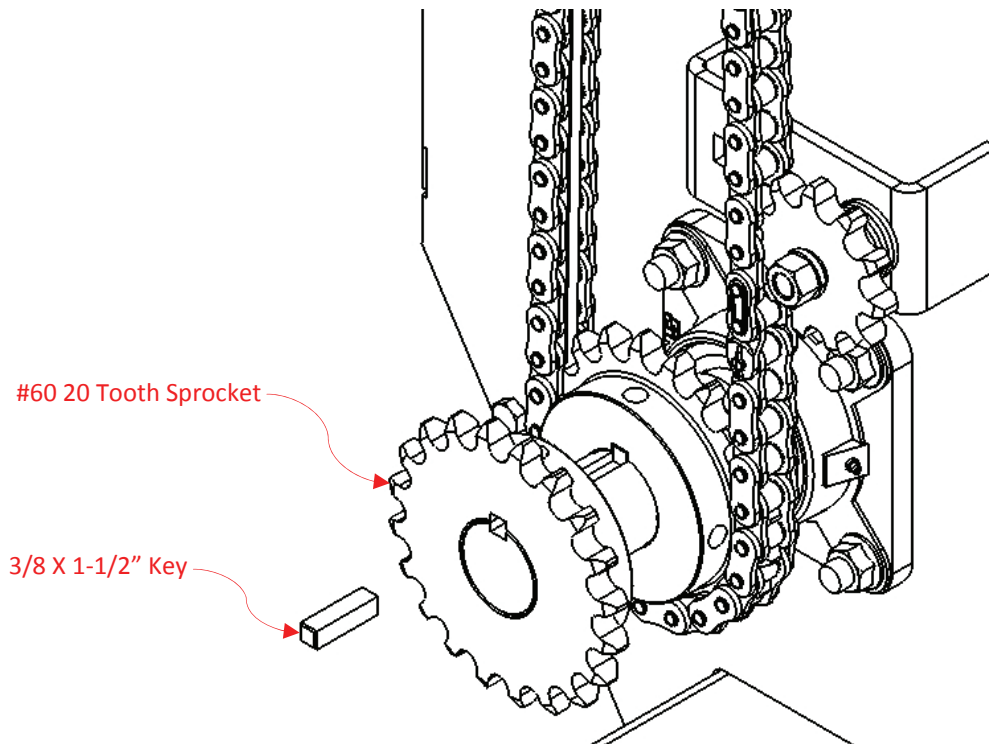

Step 3

Place gearbox mount assembly on infeed tongue as shown in figure 3.1. Place (2) 5/8 X 5-1/2" hex bolts through the lower two holes and thread on (2) 5/8" lock nuts. Tighten using a 15/16" socket & wrench. **Do not** over tighten.

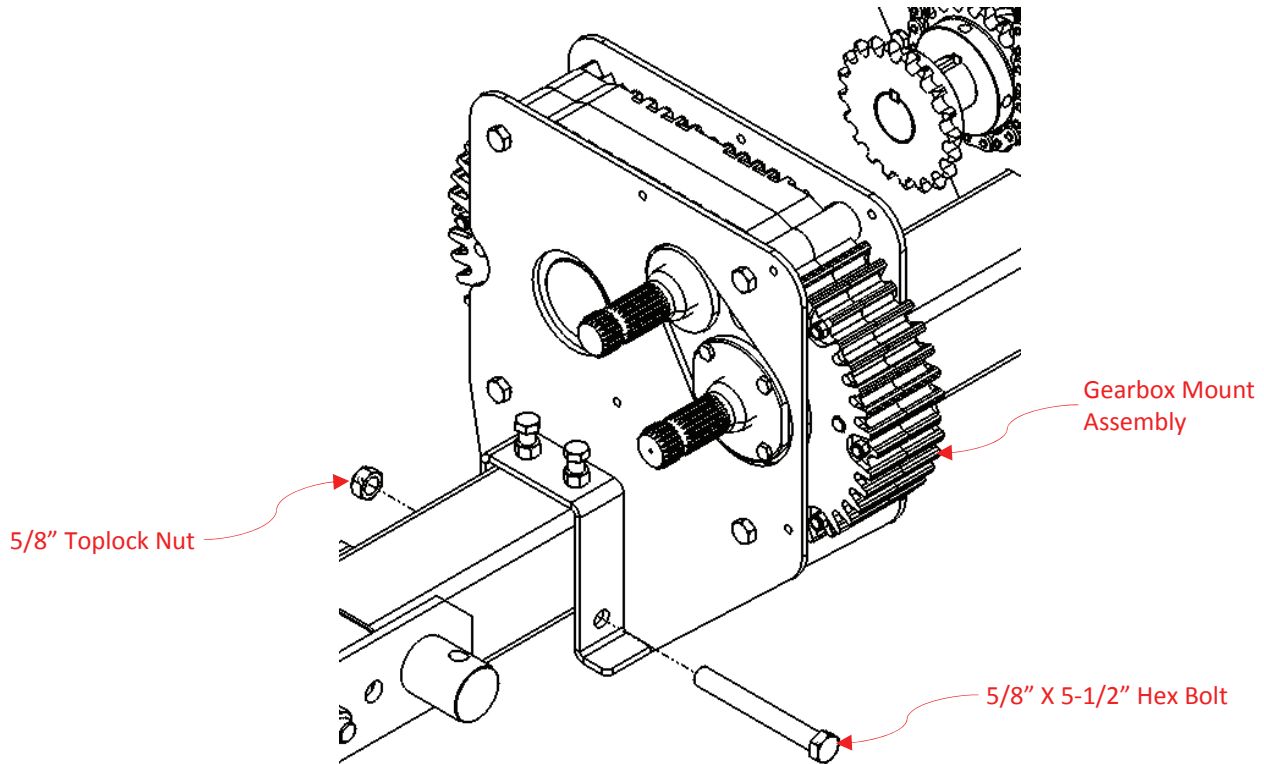

FIG 3.1

Step 4

Slide gearbox mount assembly up towards sprocket on 1-3/4" drive shaft. The sprockets should be approximately 3/8" apart. Tighten the (4) 1/2" adjustment bolts using a 3/4" wrench until the 2 sprockets are inline. Lock the bolts in place with 1/2" hex nuts. Wrap the double #60 chain around the sprockets and link together with the double #60 connector link provided.

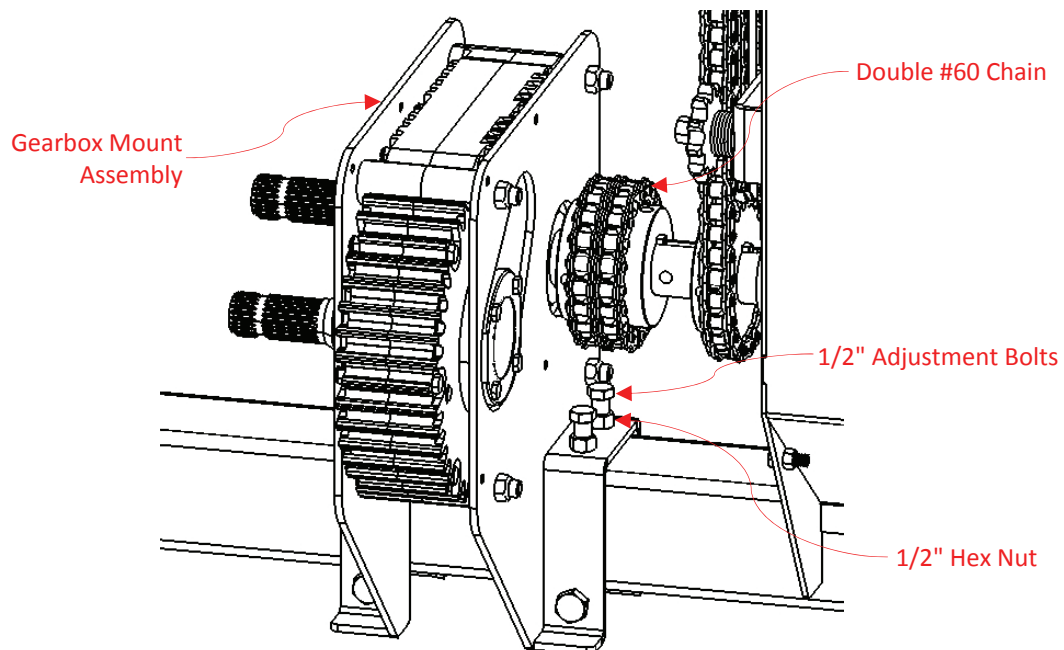

FIG 4.1

Step 5

Remove the front clevis from tongue. Insert tongue extension tube (31590) between outer tongue plates. (plates may need to be opened up for extension to fit) Jack mount must be on opposite side of original jack mount. Bolt in extension tube using a 3/4 X 6" hex bolt & lock nut. Tighten using a 1-1/8" wrench & socket. Move clevis to front of extension tube & reattach.

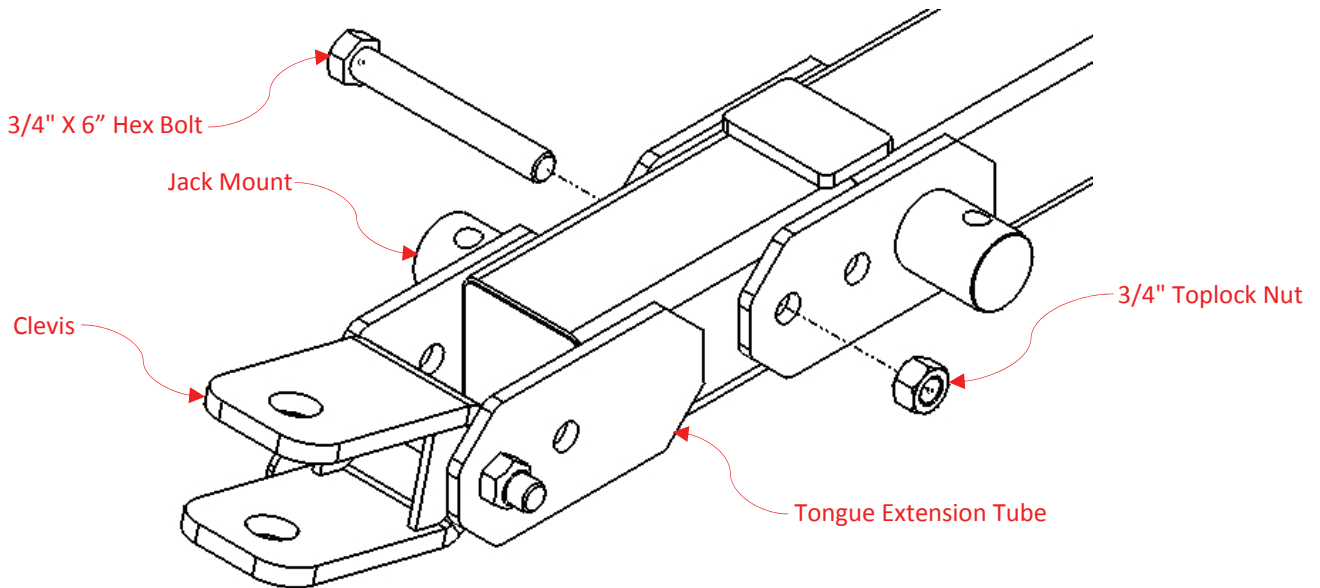

FIG 5.1

Step 6

Bolt on the new PTO support bracket (10526B) & the new drive chain shield (31591) using the 3/8" bolts & nuts removed in Step 1. Mount the PTO shaft shield (12374) using the tapped holes in the front gearbox mount bracket using (4) 3/8" X 1/2" hex flange bolts. Tighten all with 9/16" wrench & socket.

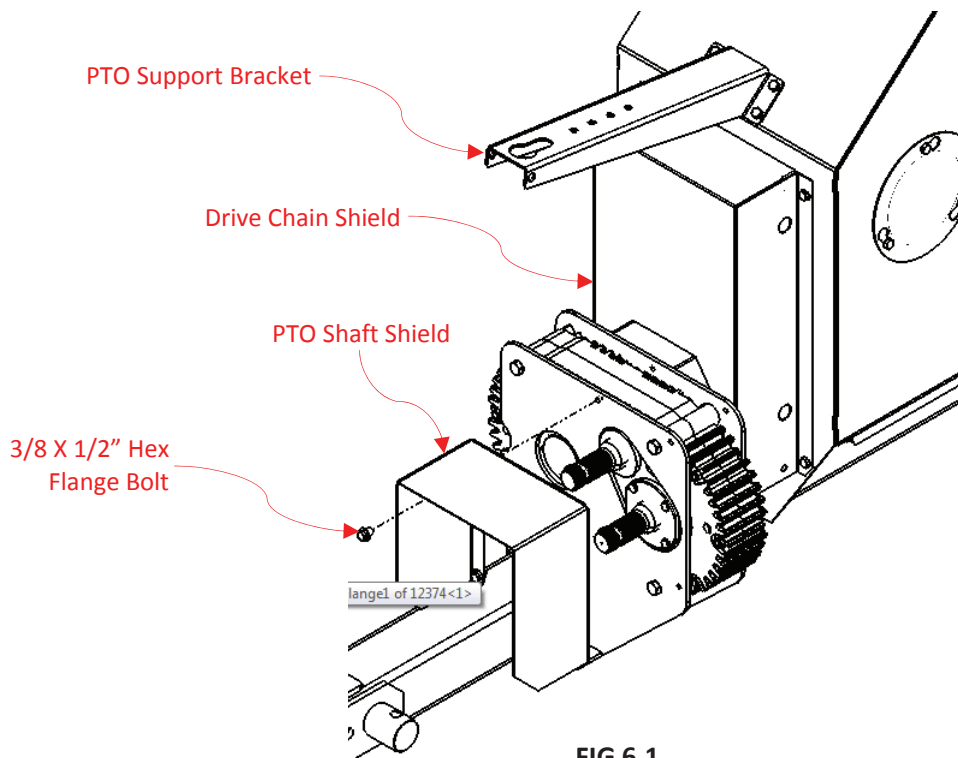

FIG 6.1

Step 7

Mount bottom shield cover (12373) to drive chain shield as shown in figure 7.1. Bottom shield cover should be slid in from bottom and attached using (4) 3/8" X 3/4" hex flange bolts. Tighten bolts using a 9/16" wrench or socket. Do not overtighten.

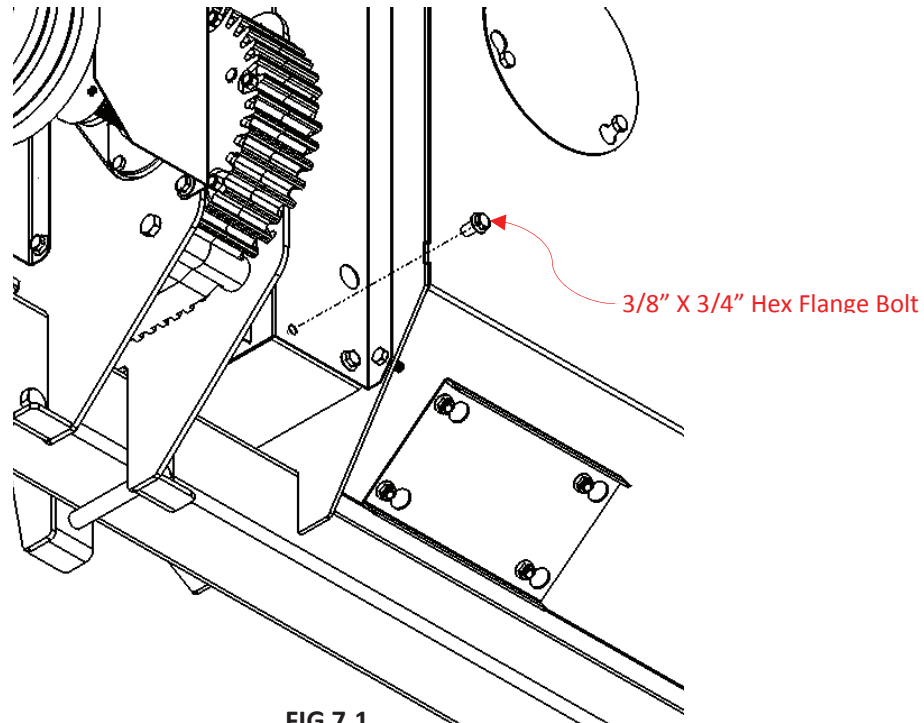

FIG 7.1

Step 8

Mount PTO shaft to gearbox. PTO shaft mounts using a ball lock coupler. PTO shaft on the tractor end can either have a 1-3/4" coupler (31498) or a 1-3/8" coupler (31499). Attach longer PTO support chain (31490) to PTO support bracket (not shown). Move jack to lower jack mount position as shown in figure 8.1. Make sure that the CV end is connected to auger.

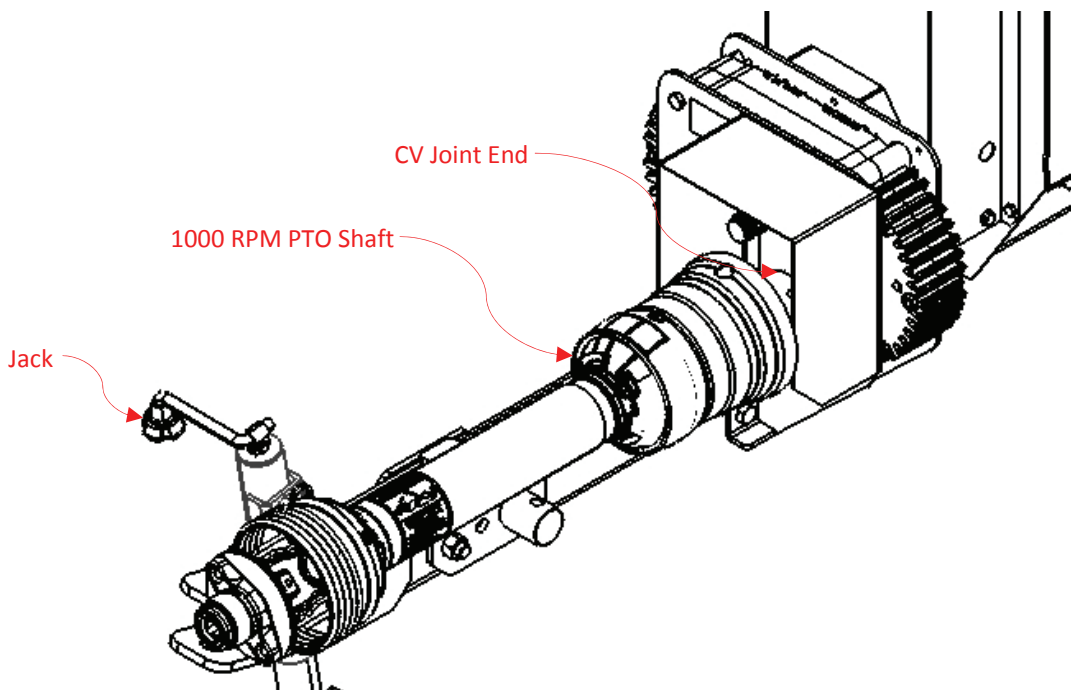
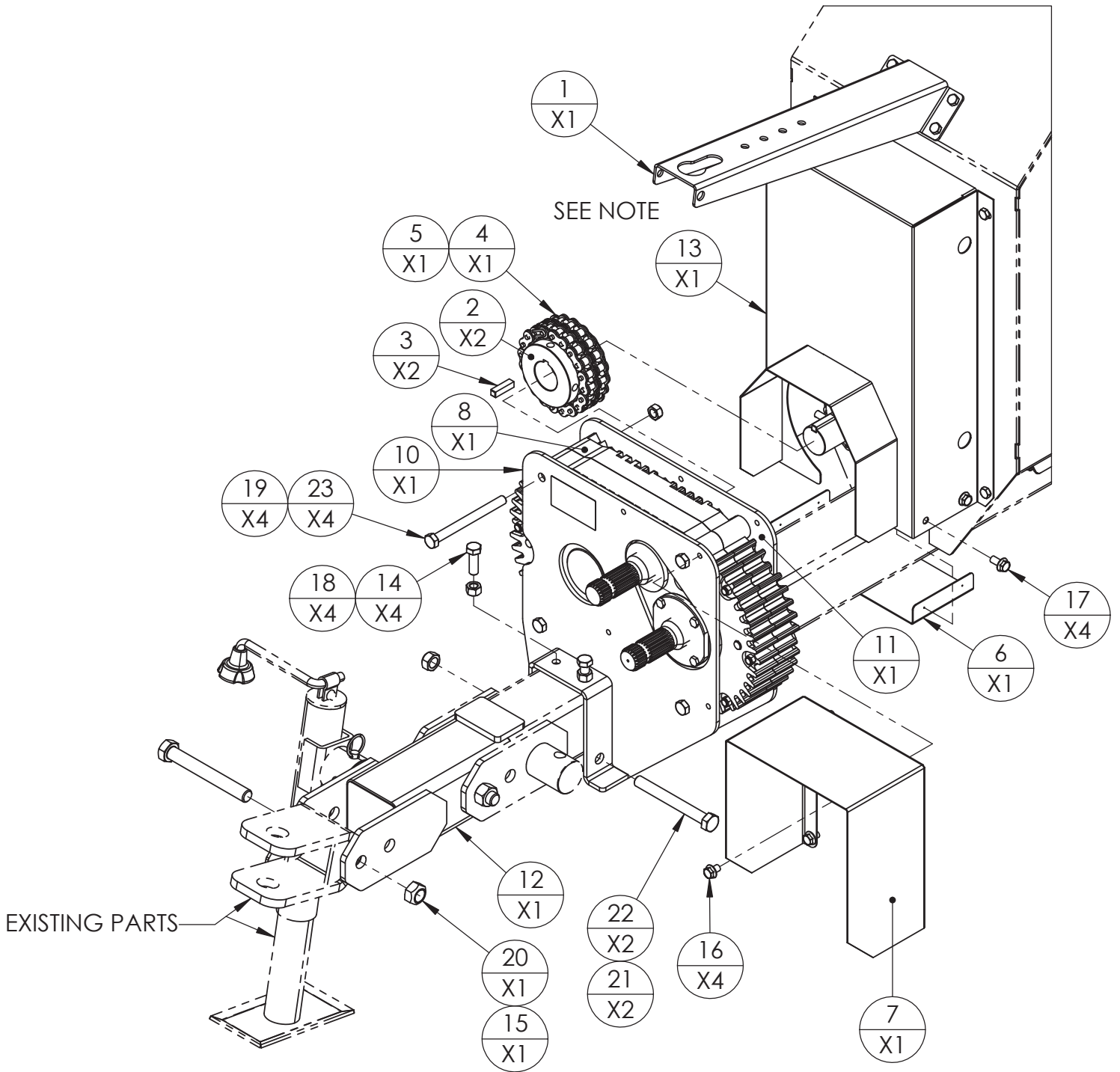
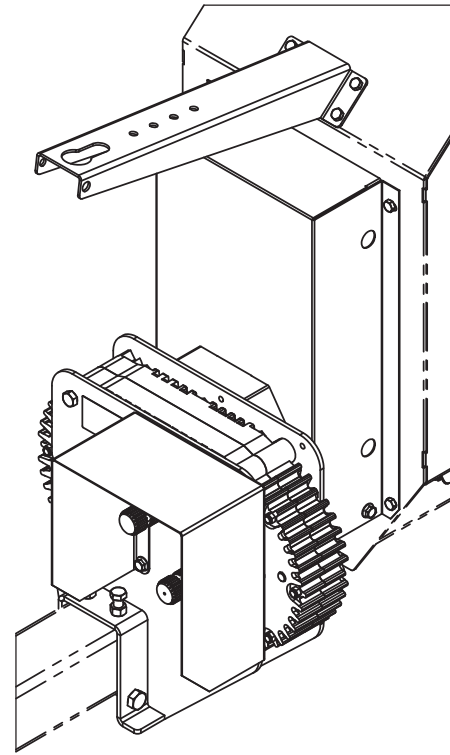
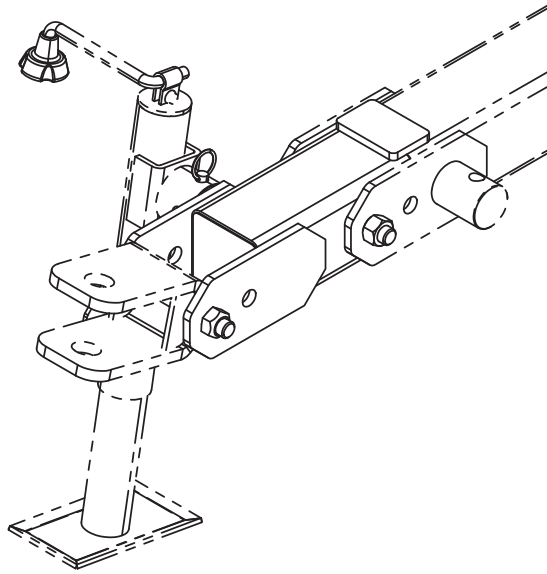

FIG 8.1



NOTES: 1) P/N 31490 IS NOT SHOWN
 2) PTO SHAFT NOT SHOWN
 P/N 31498, BIG, 1-3/4"
 P/N 31499, SMALL, 1-3/8"



| ITEM NO. | PART NO. | DESCRIPTION | QTY |
|----------|----------|--|-----|
| 1 | 10526B | BRACKET, PTO SHAFT SUPPORT, 13" REVERSER | 1 |
| 2 | 10555 | SPROCKET, #60x20, TOOTH, 1.75 BORE, 3/8 KW | 2 |
| 3 | 10578 | KEY, 3/8 X 1-1/2" SQUARE | 2 |
| 4 | 11328 | LINK, CONNECTOR, DOUBLE 60 | 1 |
| 5 | 11347 | CHAIN, DOUBLE 60X 20 ROLLERS, 13" | 1 |
| 6 | 12373 | SHIELD, BOTTOM, BOLT ON, 1000-540, H13 | 1 |
| 7 | 12374 | SHIELD, PTO, 1000-540, H13 | 1 |
| 8 | 31107 | GEARBOX, 1000-540 RPM | 1 |
| 9 | 31490 | CHAIN, SAFETY, 3/16" X 48" | 1 |
| 10 | 31523 | MNT ASM, FRONT, 1000-540 REDUCER | 1 |
| 11 | 31524 | MNT ASM, REAR, 1000-540 REDUCER | 1 |
| 12 | 31590 | TUBE ASM, EXTENSION, 1000-540 REDUCER | 1 |
| 13 | 31591 | SHIELD ASM, DRIVE CHAIN, H13XX | 1 |
| 14 | 40004 | BOLT, 1/2-13UNC X 1-1/2" HEX, GRD 5, ZINC | 4 |
| 15 | 40022 | BOLT, 3/4-10UNC X 6 HEX, GRD 5, ZINC | 1 |
| 16 | 40023 | BOLT, 3/8-16UNC X 1/2" HEX FLANGE, TC, GRD 5, ZINC | 4 |
| 17 | 40030 | BOLT, 3/8-16UNC X 3/4" HEX FLANGE, GRD 5, ZINC | 4 |
| 18 | 40046 | NUT, 1/2-13UNC, GRD 5, ZINC | 4 |
| 19 | 40048 | NUT, 1/2-13UNC, HEX, TOPLOCK, ZINC | 4 |
| 20 | 40055 | NUT, 3/4-10UNC, HEX, TOPLOCK, ZINC | 1 |
| 21 | 40062 | NUT, 5/8-11UNC, HEX, TOPLOCK, ZINC | 2 |
| 22 | 40081 | BOLT, 5/8-11UNC X 5-1/2" HEX, GRD 5, ZINC | 2 |
| 23 | 40222 | BOLT, 1/2-13UNC X 5-1/2", HEX, GRD5, ZINC | 4 |