



TO: Valued Customers and Dealers  
RE: Solution – Harvest FC1535/45 Clutch  
DATE: 2017-06-07  
VERSION: N/A  
KIT #: 13000007931-00

This **SERVICE BULLETIN** applies to all Gas Powered FC1535 and FC1545 Harvest Conveyors.

# SolK HVST FC1535/45 Clutch

Your Kit will consist of the following:

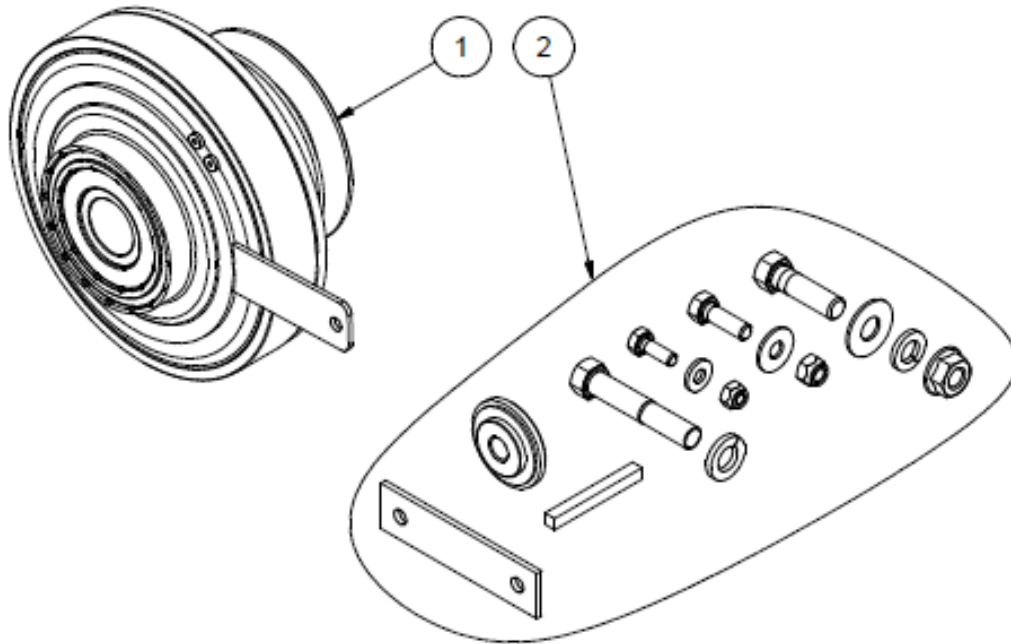

PARTS LIST OF PN# 13000007931-00			
REF #	PART #	QUANTITY	DESCRIPTION
1	13000005743-00	1	Clutch - Ogura Electric
2	13000007932-00	1	Bolt Bag - SolK HVST FC1535/45 Clutch
3	13000007931-01	1	Instructions - SolK HVST FC1535/45 Clutch

# Solk HVST FC1535/45 Clutch

Step 1:

- Unlatch Belt Guard and lift out of the way

Step 2:

- Remove Fasteners, Clutch Bracket PN 1300012910 and Rubber Clutch Bracket PN 1300012922 as shown in Figure 1
- Discard Rubber Clutch Bracket PN 12922

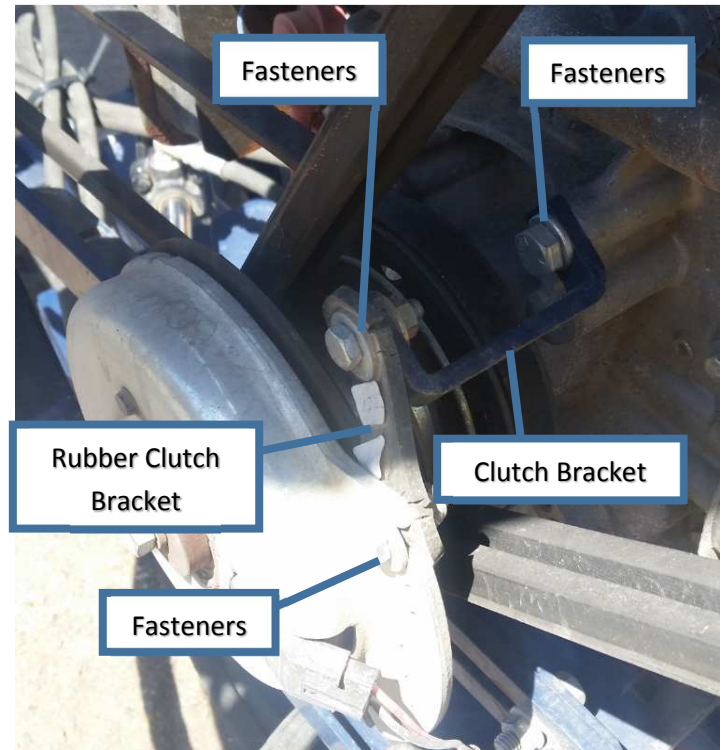

Figure 1

Step 3:

- Remove Hex Bolt and Lock Washer from the Clutch and disconnect the wires as shown in Figure 2

Step 4:

- Remove Entire Clutch from Engine Crank Shaft

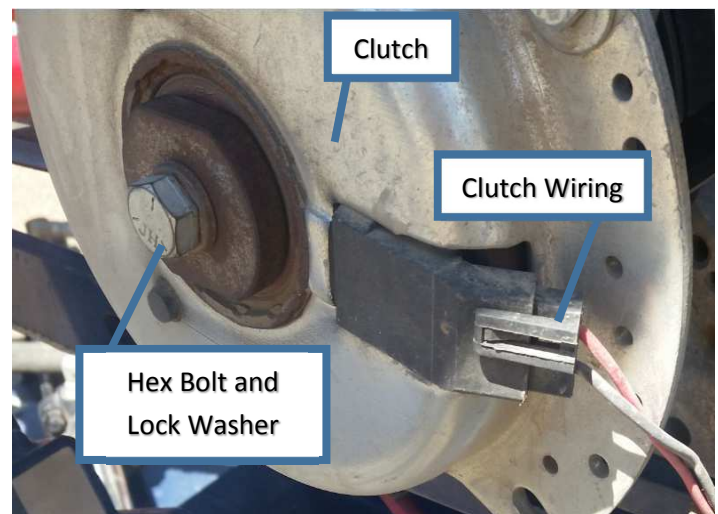

Figure 2

# Solk HVST FC1535/45 Clutch

## Step 5:

- Remove Quantity 4 of 2" OD Spacers PN 1300013246 from the Engine Crank Shaft as shown in Figure 3

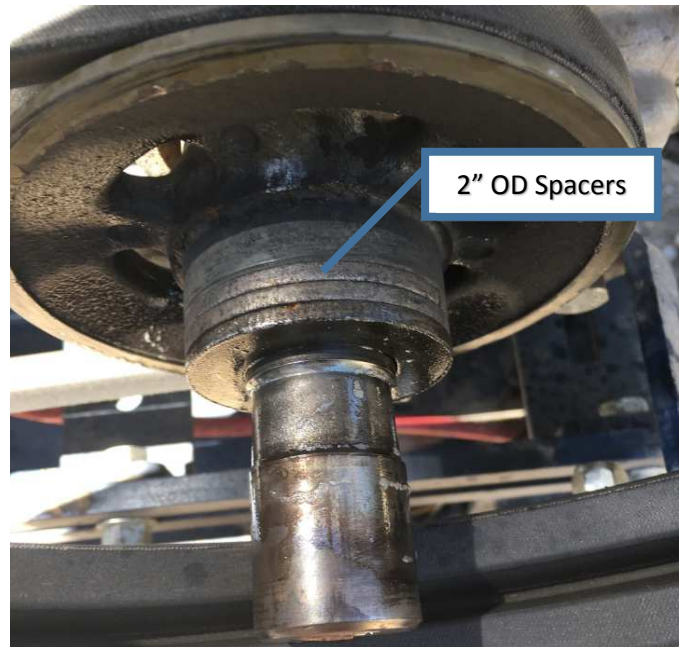

Figure 3

## Step 6:

- Install new Clutch PN 13000005743 using Square Key PN 13000006635
- Ensure the Drive Belt is around the Clutch when replacing the Clutch
- Ensure the drive sheave and the Clutch Sheave are lined up. If not, remove or add additional Washers from Step 5 until aligned

## Step 7:

- Place Stepped Washer PN 13000042255 and 7/16" x 2 1/2" Fine Thread Bolt c/w Lock Washer 3 to secure the Clutch to the Engine Shaft as shown in Figure 4

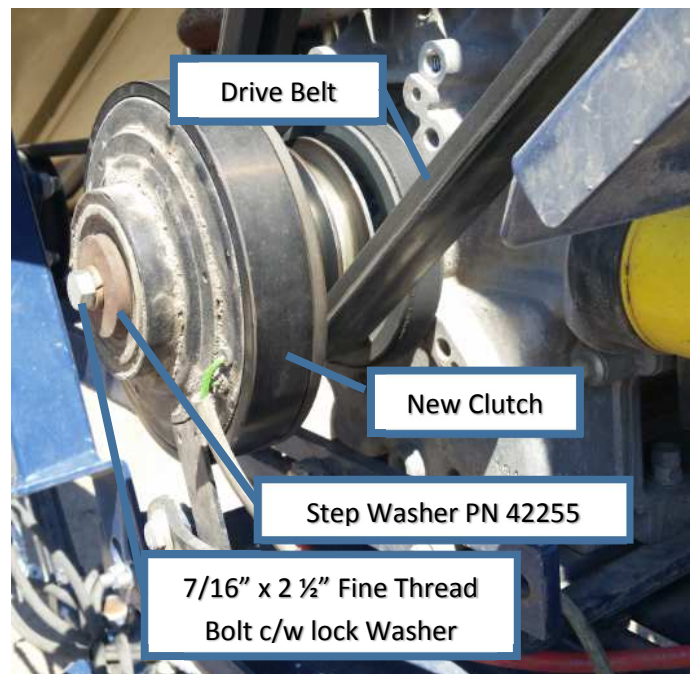

Figure 4



# Solk HVST FC1535/45 Clutch

## Step 8:

- Attach new Rubber Bracket PN 13000042262 to the clutch using  $\frac{1}{4}$ " x  $\frac{3}{4}$ " Hex Bolt c/w Flat Washer and Stover as shown in figure Figure 5

## Step 9:

- Attach The Rubber Bracket to the Clutch Bracket PN 13000012910 using  $\frac{5}{16}$ " x 1" c/w Flat Washer and Stover as shown in Figure 5
- Attach the Clutch Bracket to the Motor Mount using  $1\frac{1}{2}$ " x  $\frac{7}{16}$ " Hex Bolt c/w Flat Washer, Lock Washer and Hex Flange Nut as shown in Figure 5

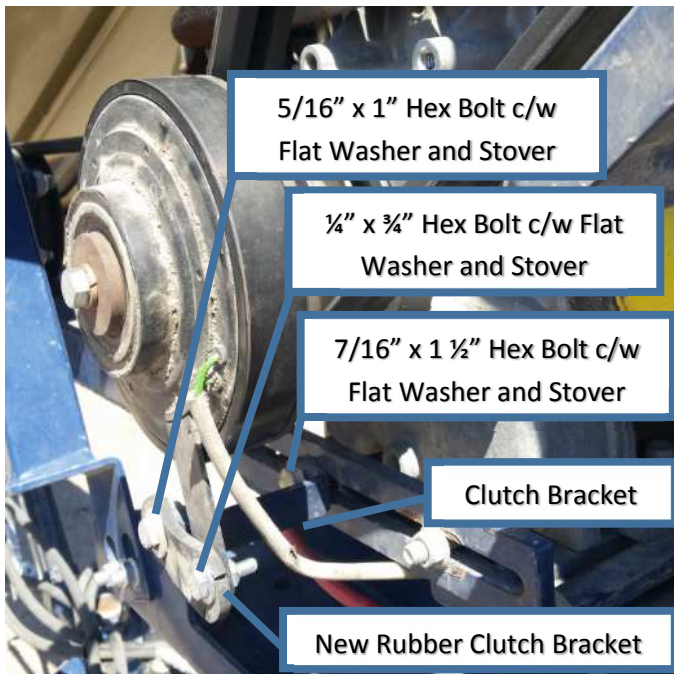

Figure 5

## Step 10:

- Loop the wire from the clutch through the Motor Mount so it is out of the way when the Belt Guard is in place
- Connect the clutch wire directly to the wire that was disconnected in Step 3 as shown in Figure 6

## Step 11:

- Secure Belt Guard in place around the Entire Assembly

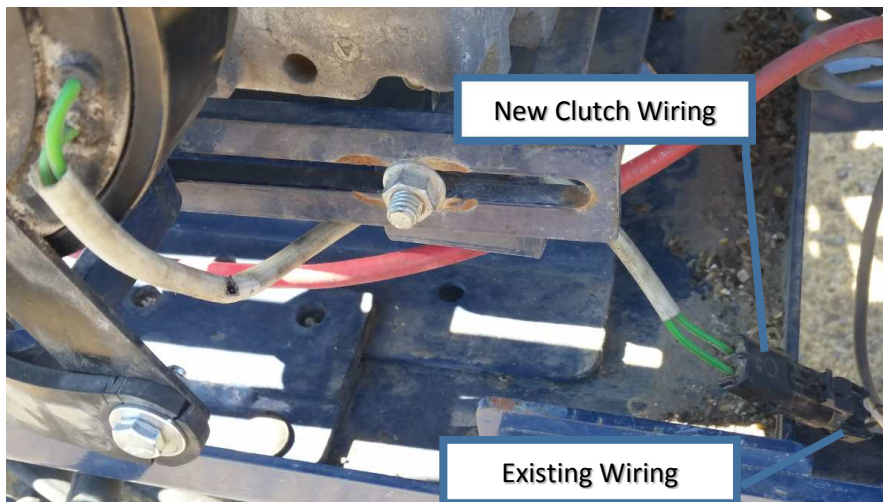

Figure 6